

**Weight** 30kg/m<sup>2</sup>  
**Module Width** 300 - 1800mm  
**Standard Module Height** 305mm minimum,  
 (increasing increments of 305mm)  
 Intermediate heights are available

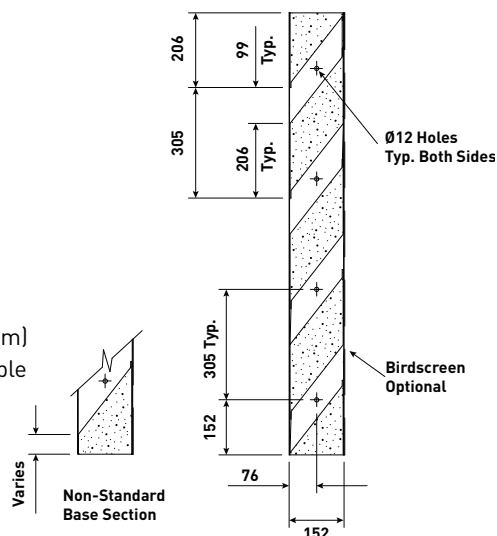

**Acoustic Performance**

| Octave Band Centre Frequency (Hz)                       | 63   | 125 | 250 | 500 | 1k | 2k | 4k | 8k |
|---|--|-----|-----|-----|----|----|----|----|
| Transmission Loss (dB)                                  | 6  | 6   | 8   | 10  | 14 | 18 | 16 | 15 |
| Acoustic Rating   | <b>R<sub>w</sub>15dB / D<sub>new</sub>21dB</b> |     |     |     |    |    |    |    |
| <b>For noise reduction, add 6dB to the above values</b> |  |     |     |     |    |    |    |    |

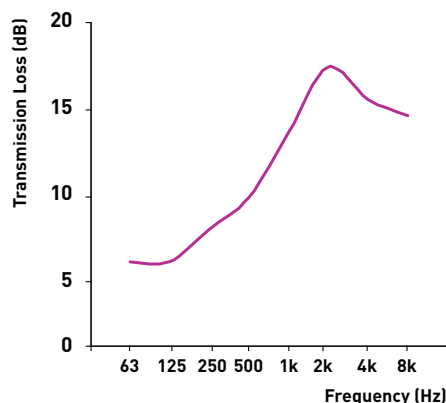

**Aerodynamic Performance**

| Static Pressure Drop (N/m <sup>2</sup> ) | 10           | 20   | 30   | 40   | 50   | 60                          | 70   | 80   | 90   | 100  |
|--|--------------|------|------|------|------|-----------------------------|------|------|------|------|
| Face Velocity (m/s)                      | 0.53         | 0.73 | 0.90 | 1.04 | 1.16 | 1.28                        | 1.37 | 1.47 | 1.56 | 1.64 |
| Nominal Free Area                        | 32%*         |      |      |      |      | * Average over louvre depth |      |      |      |      |
| Cd                                       | <b>0.127</b> |      |      |      |      |                             |      |      |      |      |

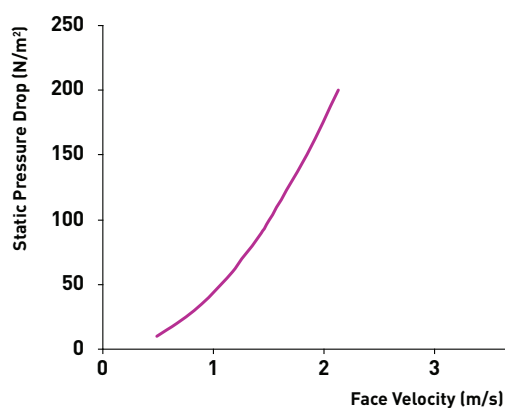

**Acoustic Louvred Doors**

- Single and double doors are available in the SL-150 louvre range
- See page 24 for further details

Errors and Omissions Excepted (E&OE).